

RECORD OF SURVEY NO. 36 - 129

IN THE TOWN OF MAMMOTH LAKES, COUNTY OF MONO, STATE OF CALIFORNIA, BEING A SURVEY OF BLOCK 9 AND A PORTION OF BLOCK 8, MAMMOTH CAMP TRACT NO. 1 AND ALSO A PORTION OF LOTS 1, 9 AND 10 OF MAMMOTH HIGHLANDS SUBDIVISION

SURVEYOR'S STATEMENT:

THIS MAP CORRECTLY REPRESENTS A SURVEY MADE BY ME OR UNDER MY DIRECTION IN CONFORMANCE WITH THE REQUIREMENTS OF THE LAND SURVEYORS' ACT AT THE REQUEST OF CARTER STREET HOMEOWNERS IN JULY 1998.

DAVID A. LAVERTY
L.S. 4587

DATE
LIC. EXP. 9-30-02

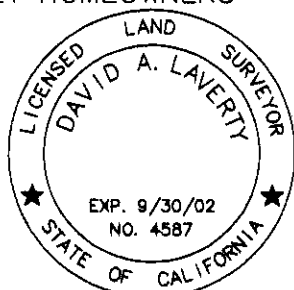

COUNTY SURVEYOR'S STATEMENT:

THIS MAP HAS BEEN EXAMINED IN ACCORDANCE WITH SECTION 8766 OF THE LAND SURVEYORS' ACT THIS 27TH DAY OF OCTOBER 1998.

DEPUTY COUNTY SURVEYOR
JOHN B. BUCK
L.S. 3884

DATE
LIC. EXP. 6-30-00

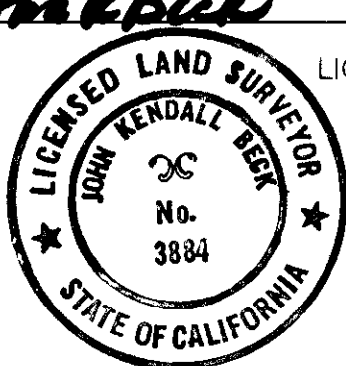

RECORDER'S STATEMENT:

FILED THIS 28th DAY OF October 1998, AT 2:39 P.M. IN BOOK 3 OF RECORD OF SURVEY MAPS AT PAGE 65 AT THE REQUEST OF CARTER STREET HOMEOWNERS.

INSTRUMENT NO. : 7285
FEE : \$7.00

RENN NOLAN
MONO COUNTY RECORDER

BY : Dolores K. W.
DEPUTY COUNTY RECORDER

LEGEND

- SET 5/8" REBAR WITH CAP, "L.S. 4587"
- FOUND MONUMENT AS NOTED
- ⊙ FOUND MONUMENT "LS 4428" AS SET, PER R7

- R1 = RECORD INFORMATION PER MAP BOOK 1 PAGE 1
R2 = RECORD INFORMATION PER MAP BOOK 1 PAGE 23
R3 = RECORD INFORMATION PER MAP BOOK 4 PAGE 39
R4 = RECORD INFORMATION PER MAP BOOK 3 PAGE 42
R5 = RECORD INFORMATION PER RSM BOOK 2 PAGE 47
R6 = RECORD INFORMATION PER RSM BOOK 2 PAGE 49
R7 = RECORD INFORMATION PER RSM BOOK 3 PAGE 32
R8 = RECORD INFORMATION PER MAP BOOK 4 PAGE 78
R9 = RECORD INFORMATION PER RSM BOOK 2 PAGE 89
R10 = RECORD INFORMATION PER RSM BOOK 3 PAGE 22

— LINE SUBJECT TO BOUNDARY AGREEMENT PER 1822/8125 O.R.

— OTHER PROPERTY LINES

--- CARTER ST. ABANDONED PER O. R. 820 PG. 120

LINE NUMBER	BEARING	LENGTH
1	S29°12'00"E	13.37'
2	S29°12'00"E	13.37'
3	S19°11'38"W	31.51'
4	N85°38'47"E	10.91'
5	N21°57'04"E	55.23'
6	S85°39'06"W	7.98'
7	N15°34'21"E	68.78'
8	N18°59'29"E	48.64'
9	S85°38'36"W	12.91'
10	N19°50'22"E	119.63'
11	S85°38'24"W	11.05'
12	S74°26'05"E	13.42'
13	N59°06'24"E	29.38'
14	S89°10'24"W	10.05'
15	N19°11'38"E	15.93'

LINE NUMBER	BEARING	LENGTH
15	S69°14'09"E	18.66'
16	N40°41'52"E	50.35'
17	S64°50'54"W	38.31'
18	S64°50'54"W	31.87'
19	S29°12'00"E	20.05'
20	S29°20'23"W	16.21'
21	S40°43'44"E	13.04'
22	S66°25'45"W	27.89'
23	N18°59'29"E	48.34'
24	N15°34'21"E	68.52'
25	N15°34'21"E	69.04'
26	N21°57'04"E	45.52'
27	N21°57'04"E	36.55'
28	N18°59'29"E	48.94'
29	N10°30'49"E	39.78'
30	S19°34'43"W	21.51'
31	S89°06'55"E	22.60'
32	S04°41'13"E	17.44'
33	S82°29'28"W	30.70'

