

CORNER RECORD

COUNTY OF ~~MONTE~~ MONTE T. 8N R. 22/23E MDO MERIDIAN CALIFORNIA
 CORNER TYPE: GOV'T. CORNER ☒ MEANDER ☐ RANCHO ☐ CONTROL ☐ OTHER ☐
 CORNER IDENTIFICATION - DATE OF VISIT March 8, 1988

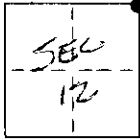

PT. # 218

CORNER - LEFT AS FOUND ☒ FOUND AND TAGGED ☐ REESTABLISHED OBLITERATED CORNER ☐ REBUILT ☐

PHYSICAL DESCRIPTION OF CORNER FOUND: EVIDENCE AND METHOD USED TO IDENTIFY OR REESTABLISH Found US660
brass cup set on 2" IP 0.7' E above ground in open pasture. Located 150' E
north of an old 1 1/2" axle, 0.4' E above ground, in barbed wire fence line that runs
east/west, and 750' E east of Hwy 395 at approximate Post Mile 111.05.

PHYSICAL DESCRIPTION OF MONUMENTS REBUILT OR PERPETUATED

CALIFORNIA COORDINATE SYSTEM ORDER: FIRST ☐ SECOND ☐ THIRD ☒
 STATIONS USED: NGS (USC & GS) ☐ STATE ☒ COUNTY ☐ OTHER ☐ STATION PM 111.0 STATION PM 111.14
 ZONE 3 ELEVATION _____ NORTHINGS (Y) 751,759 ± EASTINGS (X) 2,285,468 ±

SKETCH: (Include reference tie or witness points, remarks and topo of area)

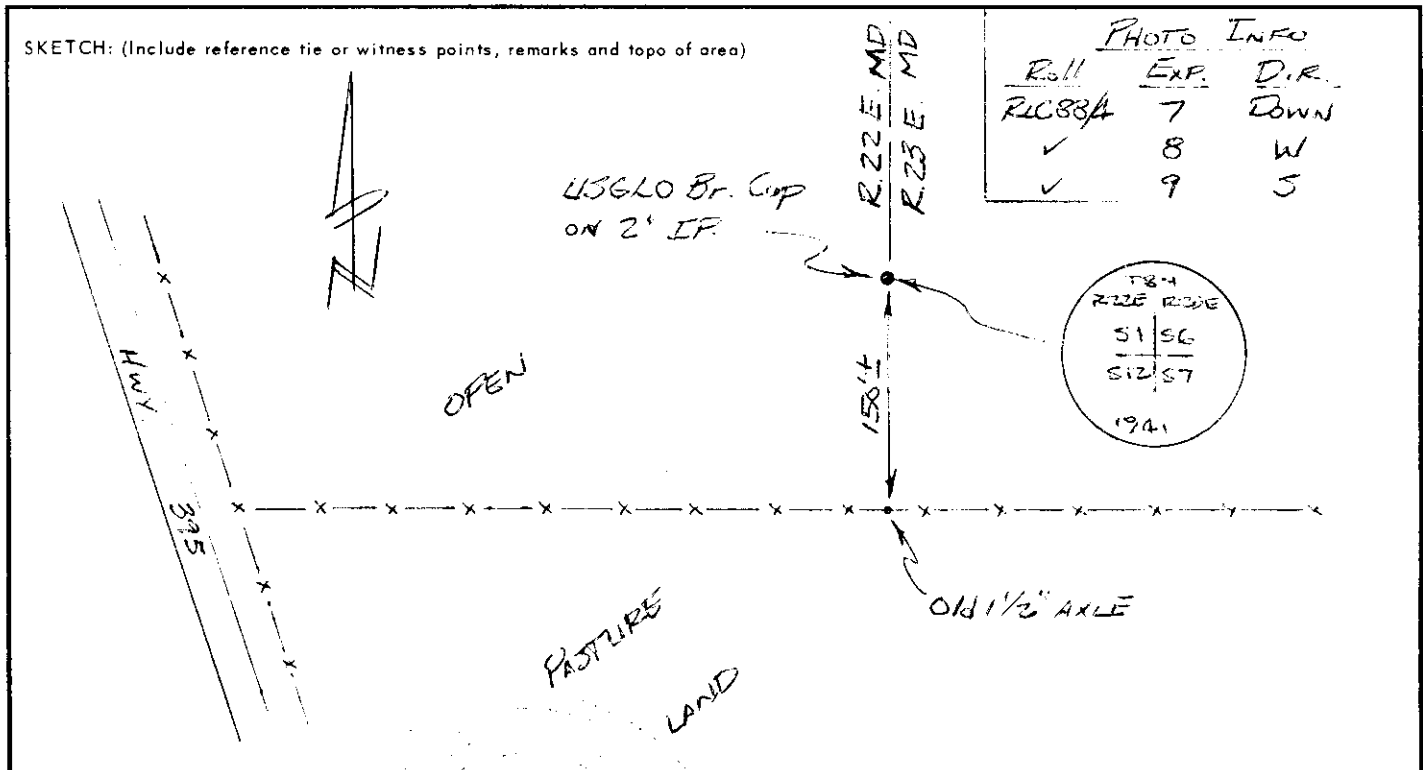

PHOTO INFO		
Roll	Exp.	D.I.R.
R1088A	7	DOWN
✓	8	W
✓	9	S

SURVEYOR'S CERTIFICATE

THIS CORNER RECORD WAS PREPARED BY ME OR UNDER MY DIRECTION IN CONFORMANCE WITH THE LAND SURVEYORS ACT ON MARCH 8, 1988

SIGNED: [Signature]

L.S. or R.C.E. No. 4468

SEAL

COUNTY SURVEYOR'S CERTIFICATE

THIS CORNER RECORD WAS RECEIVED 9-30 1988 AND EXAMINED AND FILED 9-30 1988

BY: [Signature]

TITLE: COUNTY SURVEYOR

DOCUMENT No. 8N22-12-2

STATEMENT ON BACK OF SHEET

YES ☐ NO ☒