

FINISH SCHEDULE				
ROOM NAME	FLOOR	BASE	WALL	CEILING
(100) DINING ROOM	T200 24" X 24" TILE	T109 6" X 48" TILE	P101, P104 T109 W102 WALL COVERING	C1 2' X 2' ARMSTRONG, SEPIA #PN81311 C3 GYP BOARD W/ PAINT P103
(101) SERVING AREA	QT 8" X 8" CONT. QUARRY TILE QT1 IN HIGH TRAFFIC AREAS	QT2 6" X 12" CONT. 3/4" RAD. MIN (KITCHEN EQUIPMENT ON 6" NSF APPROVED LEGS)	T109 TILE	C3 GYP BOARD W/ SMOOTH WASHABLE PAINT
(102) DRIVE-THRU STATION	QT 8" X 8" CONT. QUARRY TILE QT1 IN HIGH TRAFFIC AREAS	QT2 6" X 12" CONT. 3/4" RAD. MIN (KITCHEN EQUIPMENT ON 6" NSF APPROVED LEGS)	WP1 FRP PANEL	C2 2' X 4' SUSPENDED GRID WASHABLE VINYL COATED GYP BOARD PANELS
(103) KITCHEN	QT 8" X 8" CONT. QUARRY TILE QT1 IN HIGH TRAFFIC AREAS	QT2 6" X 12" CONT. 3/4" RAD. MIN (KITCHEN EQUIPMENT ON 6" NSF APPROVED LEGS)	WP3 S.S. BEHIND COOK LINE WP1 FRP PANEL	C2 2' X 4' SUSPENDED GRID WASHABLE VINYL COATED GYP BOARD PANELS
(104) KITCHEN PREP.	QT 8" X 8" CONT. QUARRY TILE QT1 IN HIGH TRAFFIC AREAS	QT2 6" X 12" CONT. 3/4" RAD. MIN (KITCHEN EQUIPMENT ON 6" NSF APPROVED LEGS)	WP1 FRP PANEL	C2 2' X 4' SUSPENDED GRID WASHABLE VINYL COATED GYP BOARD PANELS
(105) WALK-IN COOLER	QT 8" X 8" CONT. QUARRY TILE QT1 IN HIGH TRAFFIC AREAS	S.S. / ALUMINUM WITH 3/4" RADIUS	EXT S.S. INT ALUMINUM GALVANIZED S.S.	ALUMINUM GALVANIZED STAINLESS STEEL
(105A) WALK-IN FREEZER	GALVANIZED STAINLESS STEEL QT 8" X 8" CONT. QUARRY TILE UNDER W/F SUBFLOOR	S.S. / ALUMINUM WITH 3/4" RADIUS	EXT S.S. INT ALUMINUM GALVANIZED S.S.	ALUMINUM GALVANIZED STAINLESS STEEL
(106) MEN'S ROOM	T200 24" X 24" TILE	SCHLUTER	T108 TILE	C3 GYP BOARD W/ P101 SMOOTH WASHABLE PAINT
(107) WOMEN'S ROOM	T200 24" X 24" TILE	SCHLUTER	T108 TILE	C3 GYP BOARD W/ P101 SMOOTH WASHABLE PAINT
(108) NOT USED	-	-	-	-
(109) STORAGE ROOM	T200 24" X 24" TILE	T109 6" X 48" TILE	WP1 FRP PANEL	C3 GYP BOARD W/ P101 SMOOTH WASHABLE PAINT
(110) EXTERIOR STORAGE	SEALED CONCRETE, SMOOTH FINISH	-	WP1 FRP PANEL	C3 GYP BOARD W/ P101 SMOOTH WASHABLE PAINT

DOOR & HARDWARE SCHEDULE									
INSTALLED AND FURNISHED BY: G.C. UNLESS NOTED OTHERWISE									
CONTRACTOR TO PURCHASE DOOR HARDWARE & FRAME DIRECTLY FROM PANDA'S NATIONAL ACCOUNT SUPPLIER. SUPPLIER TO PROVIDE ALL STOREFRONT DOOR HARDWARE, P-LAM DOORS & FRAME AND HM DOOR & FRAME									
PRIMARY CONTACT FOR QUOTING, ORDERING & LOGISTICS JERRY JACOBS, PROJECT MANAGER 800-887-4307, EXT. 220 PHONE 859-881-5499 FAX jerry@locknet.com, panda@locknet.com									
SECONDARY CONTACT FOR QUOTING, ORDERING & LOGISTICS ANGIE HAINES, PROJECT MANAGER 800-887-4307 EXT. 145 PHONE 859-881-5499 FAX AngieH@locknet.com, panda@locknet.com									
NO.	DOOR MATERIAL	SIZE	FRAME	FACE/EDGE	THK	CORE	LITE	RATE	REMARKS
(D1)	ALUMINUM STOREFRONT	3'-0" X 7'-0"	ALUM.	DARK BRONZE ANODIZED ALUM.	1 3/4"	HOLLOW	GLASS	-	
(D2)	ALUMINUM STOREFRONT	3'-6" X 7'-0"	ALUM.	DARK BRONZE ANODIZED ALUM.	1 3/4"	HOLLOW	GLASS	-	PROVIDE PULL ON EXTERIOR SIDE
(D3)	S.C. WOOD (2)	3'-0" X 7'-0"	H. MTL.	PLASTIC LAMINATE PRE-FINISHED	1 3/4"	SOLID	-	-	KICKPLATE ON EACH SIDE OF DOOR
(D4)	S.C. WOOD	3'-0" X 7'-0"	H. MTL.	PLASTIC LAMINATE PRE-FINISHED	1 3/4"	SOLID	-	-	KICKPLATE ON INT. SIDE OF DOOR
(D5)	HOLLOW METAL	3'-6" X 7'-0"	H. MTL.	PAINTED	1 3/4"	INSUL.	-	-	
(D6)	HOLLOW METAL	(2) 3'-0" X 7'-0"	H. MTL.	PAINTED	1 3/4"	INSUL.	-	-	

WALL SCHEDULE		INSTALLED AND FURNISHED BY: G.C. UNLESS NOTED OTHERWISE	
NO.	DESCRIPTION		
(W1)	3-5/8" 20GA. METAL STUD WALL W/ 1/2" TYPE "X" GYP. BOARD BOTH SIDES (SEE ARCHITECTURAL DETAILS & ELEVATIONS)		
(W2)	3-5/8" 20GA. METAL STUD WALL W/ 1/2" TYPE "X" GYP. BOARD ON ONE SIDE (SEE ARCHITECTURAL DETAILS & ELEVATIONS)		
(W3)	(2) 3-5/8" 20GA. METAL STUD WALLS W/ 1/2" TYPE "X" GYP. BOARD BOTH SIDES (SEE ARCHITECTURAL DETAILS & ELEVATIONS)		
(W4)	3-5/8" 20GA. METAL STUD LOW WALL W/ 1/2" TYPE "X" GYP. BD BOTH SIDES. PROVIDE 3 1/2" KNEE-WALL BRACE/POST @ CORNERS AND @ 48" O.C.		
(W5)	6" 20GA. METAL STUD WALL W/ 1/2" TYPE "X" GYP. BOARD BOTH SIDES (SEE ARCHITECTURAL DETAILS & ELEVATIONS)		
(W6)	6" 20GA. METAL STUD WALL W/ 1/2" TYPE "X" GYP. BOARD ONE SIDE (SEE ARCHITECTURAL DETAILS & ELEVATIONS)		
(W7)	6" 20GA. METAL STUD LOW WALL W/ 1/2" TYPE "X" GYP. BOARD BOTH SIDES. PROVIDE 3 1/2" KNEE-WALL BRACE/POST @ CORNERS AND @ 48" O.C.		

WALL PANEL SCHEDULE				
INSTALLED AND FURNISHED BY: G.C. UNLESS NOTED OTHERWISE				
NO	MANUFACTURER	DESCRIPTION	MFG #	COLOR FINISH
WP1	CRANE COMPOSITES INC.	F.R.P. THICKNESS: .075	LB03.14	#636 (GRAY), SM/SM
WP2	-	S.S. PANEL (22 GA)	-	BRUSHED FINISH
WP3	-	S.S. PANEL (22 GA)	-	DIAMOND PATTERN FINISH
WP4	NOT USED			
WP5	NOT USED			
WP6	NOT USED			
WP7	NOT USED			
WP8	WOLF GORDON	PRINT WALLCOVERING	-	-
			CONTACT: CATHY DY 310.770.1165 cathy.dy@wolfgordon.com	

SPECIAL SURFACE SCHEDULE					
INSTALLED AND FURNISHED BY: G.C. UNLESS NOTED OTHERWISE					
NO	MANUFACTURER	PRODUCT	MFG #	STAIN / COLOR	FINISH
QZ-5	SELECTIVE STONE	ARTIFICIAL QUARTZ	-	BEACH SAND QUARTZ	POLISHED
QZ-6	SAMSUNG RADIANTZ	ARTIFICIAL QUARTZ	UG-950	URAL GRAY	POLISHED

INTERIOR PAINT SCHEDULE				
INSTALLED AND FURNISHED BY: G.C. UNLESS NOTED OTHERWISE				
NO	MANUFACTURER	MFG #	COLOR	REMARK
PBA5	SHERWIN-WILLIAMS	SW 7065	ARGOS	PROMAR 200, ZERO VOC, LATEX SEMI-GLOSS
PBB	NOT USED			
P101	SHERWIN-WILLIAMS	SW 6252	ICE CUBE	PROMAR 200, ZERO VOC, LATEX EGG-SHELL
P102	NOT USED			
P103	SHERWIN-WILLIAMS	SW 7032	WARM STONE	PROMAR 200, ZERO VOC, LATEX EGG-SHELL
P104	SHERWIN-WILLIAMS	SW 6155	RICE GRAIN	PROMAR 200, ZERO VOC, LATEX EGG-SHELL
P105	NOT USED			
P106	SHERWIN-WILLIAMS	SW 7020	BLACK FOX	DTM ACRYLIC GLOSS, LOW VOC
P255	SHERWIN-WILLIAMS	SW 7675	SEALSKIN	PROMAR 200, ZERO VOC, LATEX EGG-SHELL

### WALL LEGEND

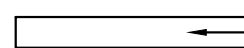
 NEW EXTERIOR WALL

 NEW EXTERIOR WALL FRAMED WITH STRUCTURAL STEEL STUDS

 NEW INTERIOR WALL (FULL HT.)

 NEW INTERIOR WALL (LOW WALL - REF. ELEV. & DETAILS)

 WALK-IN BOX PANEL

NOTE: THE FOLLOWING STAINLESS STEEL PROVIDED BY PX-INSTALLED BY G.C.:  
1. PANEL DIVIDERS AT WP3  
2. INSIDE CORNER AT WP3 TO WP2  
3. FLASHING AT TOP OF BASE WP3  
4. WP2 PIECE AT LENGTH OF WALL

NOTE: THE FOLLOWING STAINLESS STEEL PROVIDED BY G.C.-INSTALLED BY G.C.:  
5. INSTALL 18 GA STAINLESS STEEL CORNER GUARD & WALL CAP INSIDE KITCHEN

 18 GA. STAINLESS STEEL CORNER GUARD - FULL HT.

 18 GA. STAINLESS STEEL CORNER GUARD - 4'-0" HIGH

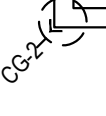
 18 GA. STAINLESS STEEL CORNER GUARD/FRAME - ALL AROUND PERIMETER OF OPENING - FRAME TO BE WELDED WITH MITERED CORNERS TO FORM SINGLE UNIT.

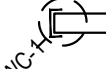
 18 GA. STAINLESS STEEL WALL CAP

ALL OTHER STAINLESS STEEL BY G.C.

NOTE:  
"G.C. TO INSTALL MIN 3-1/2" NON-COMBUSTIBLE MINERAL FIBERGLASS BATTS SOUND INSULATION AT ALL RESTROOM PARTITIONS AND CEILINGS.

\*ALL INTERIOR DIMENSIONS ARE FACE OF GYPSUM BOARD TO GYPSUM BOARD

TILE SCHEDULE (SEE SHEET A-104)

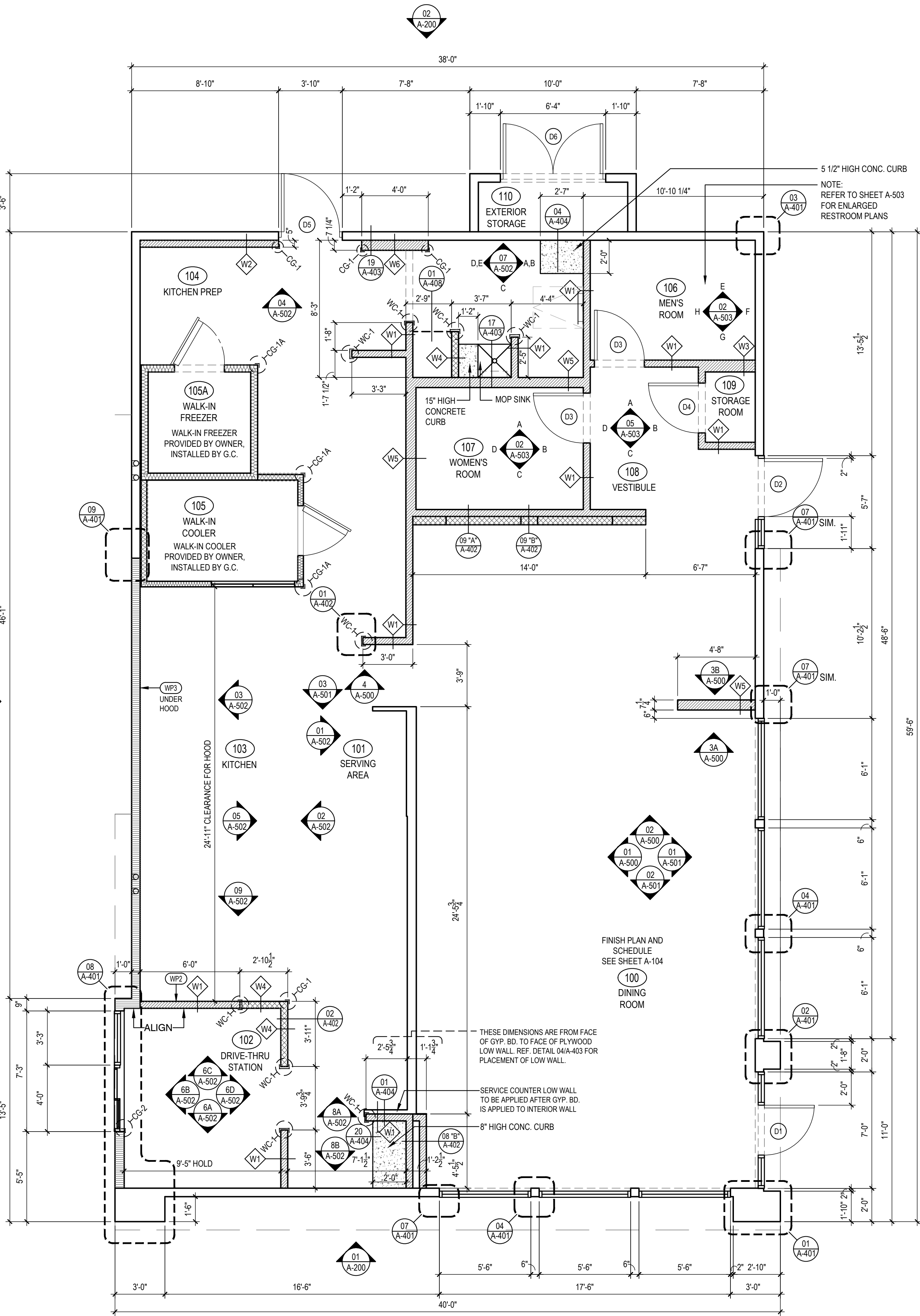

FLOOR PLAN

Scale= 1/4" = 1'-0"

1  
A-103



PANDA EXPRESS, INC.  
1683 Walnut Grove Ave.  
Rosemead, California  
91770

Telephone: 626.799.9898  
Facsimile: 626.372.8288

All ideas, designs, arrangement and plans indicated or represented by this drawing are the property of Panda Express Inc. and were created for use on this specific project. None of these ideas, designs, arrangements or plans may be used by or disclosed to any person, firm, or corporation without the written permission of Panda Express Inc.

REVISIONS:



ISSUE DATE:

1st	PERMIT SET	10-5-18
2nd	BID SET	11-20-18

DRAWN BY:

PANDA PROJECT #: S8-19-D6462

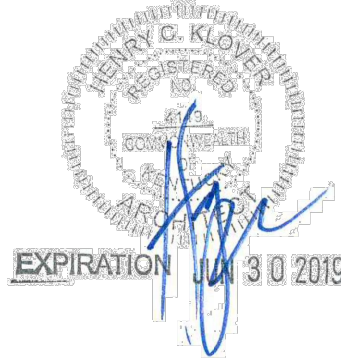
ARCH PROJECT #: 18044.013



**Khckloverarchitect**

10955 LOWELL AVENUE, SUITE 700  
OVERLAND PARK, KS 66210  
ph: 913.649.8181 • fx: 913.649.1275

**PANDA EXPRESS**

TRUE WARM & WELCOME 2200  
Conestoga Pkwy & Historical Trail  
Shepherdsville, KY, 40165

**A-103**

FLOOR PLAN

TRUE WARM & WELCOME 2200

BID SET 11.20.18