

# RECORD OF SURVEY NO. 36 - 134

IN THE TOWN OF MAMMOTH LAKES, MONO COUNTY, CALIFORNIA  
BEING A SURVEY OF LOTS 12, 13 AND 14 AND A PORTION OF LOT 15 OF BLOCK 7,  
MAMMOTH CAMP TRACT NO. 1, AS RECORDED IN MAP BOOK 1 PAGE 1, AND ALSO BEING  
A SURVEY OF A LOT LINE ADJUSTMENT OF LOTS 14 AND 15 AS DEFINED BY COURT STIPULATION  
AND SHOWN ON EXHIBIT "C" VOLUME 292 PAGE 136 RECORDED IN THE OFFICE  
OF THE MONO COUNTY RECORDER. BEING LOCATED IN THE WEST 1/2 OF SEC. 3,  
T.4S., R.27E., M.D.B. & M.

## SURVEYOR'S STATEMENT:

THIS MAP CORRECTLY REPRESENTS A SURVEY MADE  
BY ME OR UNDER MY DIRECTION IN CONFORMANCE  
WITH THE REQUIREMENTS OF THE LAND SURVEYORS'  
ACT AT THE REQUEST OF GISELA WILLET AND JUDY DALRYMPLE  
IN NOVEMBER 1999.

DAVID A. LAVERY  
L.S. 4587  
DATE 1/2/01  
LIC. EXP. 9-30-02

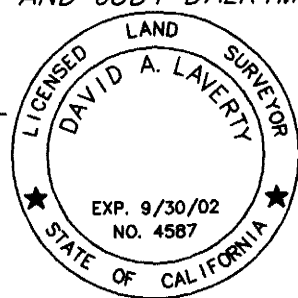

## COUNTY SURVEYOR'S STATEMENT:

THIS MAP HAS BEEN EXAMINED IN ACCORDANCE WITH  
SECTION 8766 OF THE LAND SURVEYORS' ACT THIS  
10TH DAY OF JANUARY 2001.

COUNTY SURVEYOR  
RICHARD BOARDMAN  
L.S. 4686  
DATE 1/2/01  
LIC. EXP. 9-30-03

## RECORDER'S STATEMENT:

FILED THIS 10TH DAY OF JANUARY 2001.  
AT 2:42 P.M. IN BOOK 3 OF RECORD OF  
SURVEY MAPS AT PAGE 83 AT THE REQUEST  
OF GISELA WILLET AND JUDY DALRYMPLE.

INSTRUMENT NO.: 2001000196  
FEE: \$7.00

RENN NOLAN  
MONO COUNTY RECORDER

BY: Dolores Kulas  
DEPUTY COUNTY RECORDER

## LEGEND

- SET 5/8" REBAR WITH CAP, "L.S. 4587"
- SET BOAT SPIKE & TAG, "L.S. 4587"
- FOUND MONUMENT AS NOTED
- P PROPORTIONED
- CFR CALCULATED FROM RECORD
- M MEASURED

- R1 RECORD INFORMATION PER MAP BOOK 1 PAGE 1
- R2 RECORD INFORMATION PER RSMB. 1 PAGE 39
- R3 RECORD OF SURVEY 36-4 (UNRECORDED) ON FILE, MONO CNTY PUBLIC WORKS
- R4 EXHIBIT "C" OR. VOL. 292 PG. 136
- R5 UNRECORDED LOT SURVEY FOR QUIGLEY BY GORDON HOLMES "RCE 10467" IN 1972  
FIELD BOOK 46, PAGES 40 & 60, GORDON HOLMES ARCHIVES IN BISHOP OFFICE OF TRIAD/ HOLMES ASSC.



## BASIS OF BEARINGS

THE BASIS OF BEARINGS FOR THIS SURVEY IS  
BETWEEN FOUND MONUMENTS AT THE NW CORNER  
OF LOT 12 AND THE NE CORNER OF LOT 13 AS  
SHOWN ON RSMB 1/39 AND LISTED HEREON AS  
N 89°53'30" W

