

CORNER RECORD

Agency Index

BK /// PG 7

Document Number

CR 11504

City of OAKLANDCounty of ALAMEDA, CaliforniaBrief Legal Description WELL MONUMENT LOCATED WITHIN MARKET ST
AT THE INTERSECTION OF 55TH ST

CITY OF OAKLAND MON ID: 36-A-6

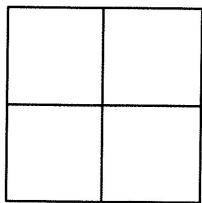

CORNER TYPE

Government Corner	<input type="checkbox"/>	Control	<input checked="" type="checkbox"/>
Meander	<input type="checkbox"/>	Property	<input type="checkbox"/>
Rancho	<input type="checkbox"/>	Other	<input type="checkbox"/>

Date of Survey 5/15/18

COORDINATES (Optional)

N. _____ E. _____

Elevation _____

Units Metric ☐ U.S. Survey Foot ☐

Horizontal Datum _____

Zone _____ Epoch Date _____

Vertical Datum _____

☐ Complies with Public Resources Code §§8801-8819☐ Complies with Public Resources Code §§8890-8902PLS Act Ref: ☐ 8765(d)☒ 8771☐ 8773☐ Other:Corner/
Monument: ☒ Left as found☐ Established☐ Rebuilt☒ Pre-Construction☐ Found and tagged☐ Reestablished☒ Referenced☐ Post-Construction

Narrative of corner identified and monument as found, set, reset, replaced, or removed:

☐ See sheet #2 for description(s) :

FOUND 2.5" BRASS DISK AND PUNCH IN MONUMENT WELL.

FOUND AND SET POINTS AS SHOWN ON PAGE 2.

THIS POINT WAS REFERENCED PRIOR TO A CONSTRUCTION PROJECT IN THE VICINITY.

THE TIES SHOWN HEREON ARE FOR THE PURPOSE OF PERPETUATING FOUND MONUMENTATION.
NO CLAIM IS MADE AS TO THE RELATIONSHIP OF THE POINTS OR LINES SHOWN HEREON TO TRUE
BOUNDARY LOCATION.

SURVEYOR'S STATEMENT

This Corner Record was prepared by me or under my direction in conformance with

the Professional Land Surveyors' Act on JUNE 4, 2018.Signed Scott V Cunha P.L.S. or R.C.E. No. LS 8525

SCOTT V. CUNHA

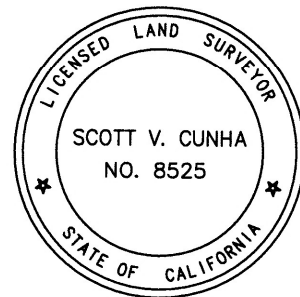

COUNTY SURVEYOR'S STATEMENT

This Corner Record was received 5 JUNE 2018and examined and filed 2 AUGUST 2018Signed Michael Rubner P.L.S. or R.C.E. No. 6843Title COUNTY SURVEYOR

County Surveyor's Comment



SCALE: 1"=30'

LEGEND

- FOUND 2.5" BRASS DISK AND PUNCH IN MONUMENT WELL
- SET REBAR & CAP
- ⊗ SET CUT CROSS IN WALK
- ⊗ SET MAG & SHINER "CUNHA RP"
- ⊗ SET CUT CROSS IN CURB

(19592) REFERENCE STREET ADDRESS

