

**2 Baffle Detail**  
A121 SCALE: 1 1/2" = 1'-0"

**3 Soffit Detail**  
A121 SCALE: 1 1/2" = 1'-0"

**4 Baffle Detail**  
A121 SCALE: 1 1/2" = 1'-0"

**5 Acoustical Lay-in Ceiling Detail**  
A121 SCALE: 1/4" = 1'-0"

- METAL SUSPENSION SYSTEM FOR ACOUSTICAL TILE AND LAY-IN PANEL CEILINGS SHALL CONFORM TO THE REQUIREMENTS OF ASTM C635-87 FOR INTERMEDIATE DUTY SYSTEMS. CEILING GRID SUSPENSION SYSTEM IN KITCHEN / FOOD PREP AREAS TO BE ALL ALUMINUM. NO CLAD.
- INSTALLATION OF METAL CEILING SUSPENSION SYSTEM FOR ACOUSTICAL TILE AND LAY-IN PANELS SHALL CONFORM TO THE REQUIREMENT OF ASTM C636-86.
- MAIN RUNNERS @ 2'-0" O.C. CROSS RUNNERS @ 2'-0" O.C.
- VERTICAL HANGERS TO BE MAX. 8" FROM WALLS
- LIGHTING FIXTURES AND DIFFUSERS IN GRID CEILING MAY BE EITHER FASTENED TO CEILING GRID SYSTEM WITH CLIPS OR FIXTURES MAY BE INDEPENDENTLY SUPPORTED FROM THE BUILDING STRUCTURAL MEMBERS WITH NO. 12 WIRE AT EACH FIXTURE CORNER.

## REFLECTED CEILING LEGEND

- 5/8" G.W.B CEILING (SMOOTH FINISH).
- 2' x 2' SUSPENDED CEILING GRID SYSTEM WITH 2' x 2' LAY-IN ACOUSTICAL CEILING TILES
- 2' x 2' SUSPENDED CEILING GRID SYSTEM WITH 2' x 2' VINYL COATED LAY-IN ACOUSTICAL CEILING TILES
- 2' x 2' SUSPENDED CEILING GRID SYSTEM WITH 2' x 2' METAL COATED LAY-IN ACOUSTICAL CEILING TILES
- 2' x 2' L.E.D. LIGHT- SEE ELECTRICAL DRAWINGS
- 2' x 2' L.E.D. EMERGENCY LIGHT FIXTURE- SEE ELECTRICAL DRAWINGS
- 2' x 4' L.E.D. LIGHT FIXTURE - SEE ELECTRICAL DRAWINGS
- WALK IN COOLER LIGHT - SEE ELECTRICAL DRAWINGS
- UTILITY LIGHT - SEE ELECTRICAL DRAWINGS
- PENDANT LIGHT 6'-6" A.F.F. U.O.N. - SEE ELECTRICAL DRAWINGS
- CAN LIGHT - SEE ELECTRICAL DRAWINGS
- EMERGENCY LIGHT - SEE ELECTRICAL DRAWINGS
- EXTERIOR EMERGENCY LIGHT - SEE ELECTRICAL DRAWINGS
- EXIT EMERGENCY COMBO LIGHT - SEE ELECTRICAL DRAWINGS
- EXIT SIGN - SEE ELECTRICAL DRAWINGS
- MECHANICAL SUPPLY REGISTER - SEE MECHANICAL DRAWINGS
- MECHANICAL SIDE WALL SUPPLY REGISTER - SEE MECHANICAL DRAWINGS
- MECHANICAL RETURN REGISTER - SEE MECHANICAL DRAWINGS
- EXHAUST FAN - SEE MECHANICAL DRAWINGS

## GENERAL NOTES

- SEE ELECTRICAL DRAWINGS FOR ALL LIGHT FIXTURE SPECIFICATIONS.
- COORDINATE AND VERIFY ALL LIGHTING FIXTURE INFORMATION, TYPES AND FINAL LOCATIONS WITH REFLECTED CEILING PLAN.
- GENERAL CONTRACTOR TO NOTIFY ARCHITECT OF ANY DISCREPANCIES PRIOR TO COMMENCING WITH ANY WORK.
- SEE SHEET ID111 FOR CEILING GRID AND TILE SPECIFICATIONS.
- CONNECT SHEATHING TO STUDS AS SPECIFIED WITH THE STRUCTURAL DRAWINGS.
- VERIFY LOCATIONS AND QUANTITY OF CEILING SPEAKERS WITH OWNER.

## CONSTRUCTION NOTES

- EXHAUST HOOD - SEE MECHANICAL DRAWINGS.
- PRE-FABRICATED HANGER ROD CANOPY BY G.C. - SEE EXTERIOR ELEVATIONS.
- CEILING MOUNTED MONITOR - INSTALL ON CEILING MOUNTED ELECTRICAL DROP SEE EQUIPMENT PLAN AND ELECTRICAL DRAWINGS.
- BAFFLE - SEE CEILING DETAILS.
- G.C. TO PROVIDE LOWER CEILING AROUND HVAC DUCTWORK INTO THE DRY GOODS STORAGE AREA. LAY-IN CEILING TILES TURNED VERTICAL TO CREATE BOX-OUT - SEE MECHANICAL DRAWINGS AND ENLARGED DETAIL 7/A502.
- CEILING LIGHT FIXTURE - SEE ELECTRICAL DRAWINGS.
- EXTERIOR LIGHT FIXTURE - SEE ELECTRICAL DRAWINGS.
- BUILDING SIGN - SEE EXTERIOR ELEVATIONS.
- BOTTOM OF PENDANT AT 6'-6" A.F.F.
- PENDANTS LIGHTS - SEE ELECTRICAL DRAWINGS.
- NON-COMBUSTIBLE CEILING TILES 18" MIN. AROUND HOOD.
- VINYL COATED CEILING TILES.
- ACOUSTICAL CEILING TILE - SEE CEILING FINISH PLAN.
- EMERGENCY LIGHT FIXTURE - SEE ELECTRICAL DRAWINGS.
- ALIGN SOFFIT WITH BACK EDGE OF COUNTERTOP.
- SOFFIT TO BE 2" PAST FRONT EDGE OF COUNTERTOP.
- ALIGN SOFFIT WITH END OF WALL.
- STAINLESS STEEL CHASE BELOW - SEE EQUIPMENT PLAN.
- CENTER OVERHEAD BAFFLE ON WALL BELOW.
- GYP/SUM BOARD CEILING.
- OVERHEAD DESK SHELF BY GC - SEE EQUIPMENT DRAWING.
- 2x6 CEILING JOIST AT 24" o.c.
- INSULATED PANEL CEILING COVERED W/ALUMINUM BY VENDOR.

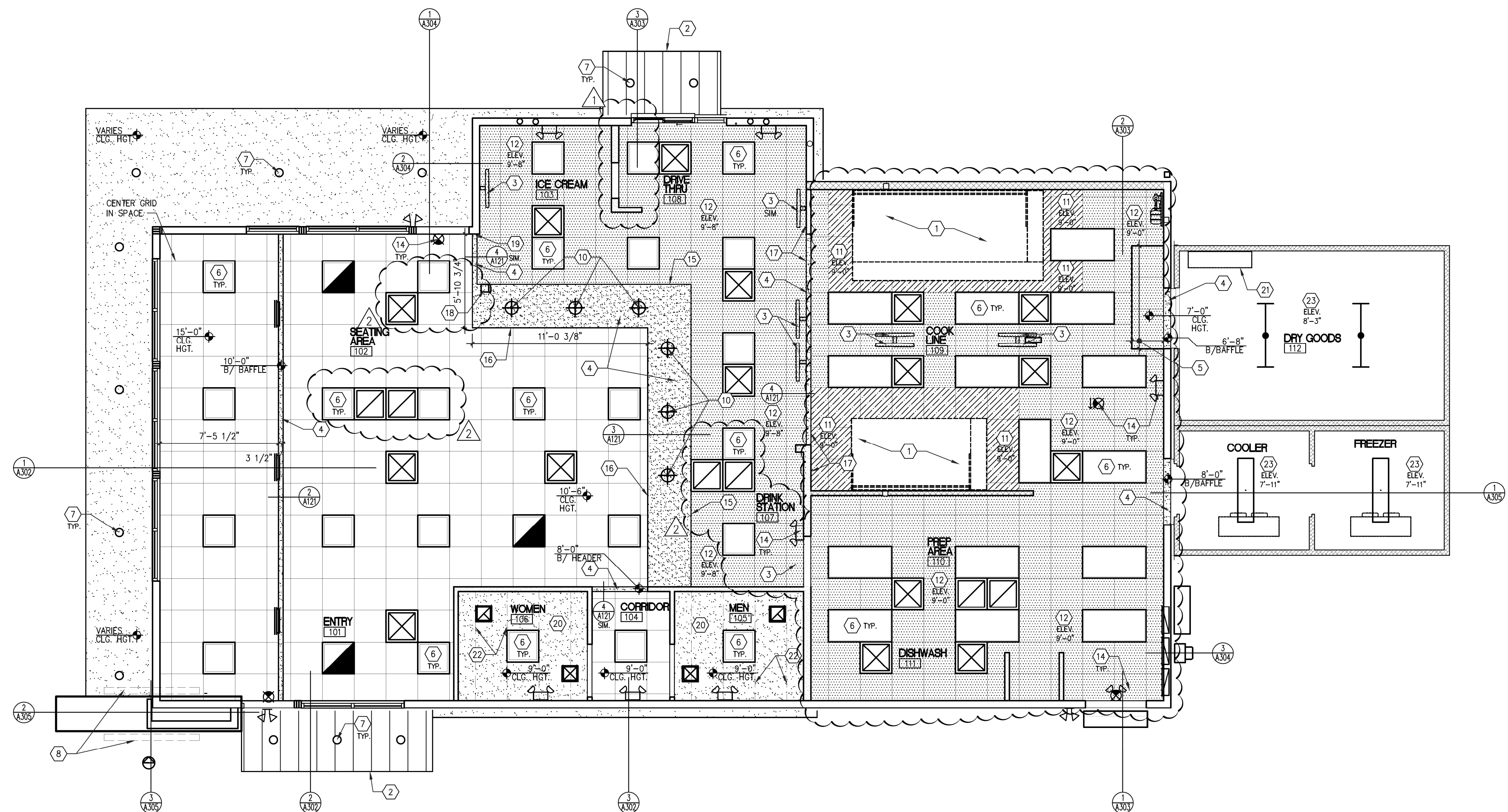

**1 REFLECTED CEILING PLAN**  
A121 SCALE: 1/4" = 1'-0"

## Revisions

THRU ADDENDUM "A"	01/20/2022
ADDENDUM "A" - 4.26.2022	
EQUIP. UPDATE - 06.24.2022	

PROJECT DATE  
01/07/2022

Drawn By  
CIH

Checked By  
GRL

Sheet No.

**A121**