

CORNER RECORD

Document Number CR 6419

City of OAKLAND County of ALAMEDA, California

Brief Legal Description WELL MONUMENT LOCATED WITHIN HIGH STREET AND QUIGLEY PLACE.

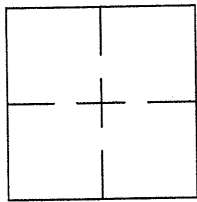

CORNER RECORD

COORDINATES  
(Optional)

Government Corner ☐ Control ☒  
Meander ☐ Property ☐  
Rancho ☐ Other ☐  
Date of Survey 8/8/2014

N. \_\_\_\_\_  
E. \_\_\_\_\_  
Zone \_\_\_\_\_ Datum \_\_\_\_\_  
Elev. \_\_\_\_\_

Corner — Left as found ☒ Found and tagged ☐ Established ☐ Reestablished ☐ Rebuilt ☐

Identification and type of corner found: Evidence used to identify or procedure used to establish or reestablish the corner:  
FOUND IRON PIN IN WELL MONUMENT IN INTERSECTION OF HIGH STREET & QUIGLEY PLACE.  
AS SHOWN ON CITY OF OAKLAND MONUMENT MAP, PAGE 155.  
NO CITY MONUMENT DESIGNATION NUMBER AT SUBJECT LOCATION.  
THIS POINT WAS REFERENCED PRIOR TO A CONSTRUCTION PROJECT IN THE VICINITY.

A description of the physical condition of the monument as found and as set or reset: \_\_\_\_\_  
FOUND AND SET POINTS AS SHOWN ON PAGE 2.  
THESE TIES ARE FOR THE PURPOSE OF PERPETUATING THE FOUND MONUMENTATION.  
NO CLAIM IS MADE AS TO THE RELATIONSHIP OF THE POINTS OR LINES SHOWN HEREON  
TO TRUE BOUNDARY LOCATIONS.

SURVEYOR'S STATEMENT

This Corner Record was prepared by me or under my direction in conformance with  
the Land Surveyors' Act on AUGUST 15, 2014.  
Signed Vincent H. Cunha L.S. Number LS 4520  
VINCENT H. CUNHA

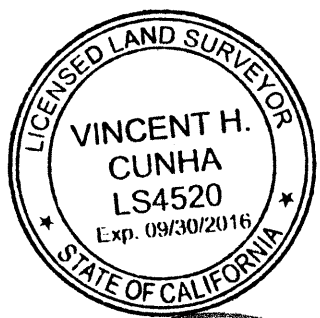

COUNTY SURVEYOR'S STATEMENT

This Corner Record was received 8-15-14 and examined  
and filed 9-3-14  
Signed Russell R. Penland Title COUNTY SURVEYOR

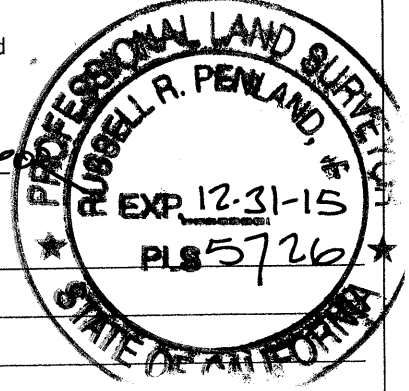

County Surveyor's Comment \_\_\_\_\_  
\_\_\_\_\_  
\_\_\_\_\_

